

# LUXYLED EVO10 MULTIBENDING

BORN TO SHINE  
**PROMOTECH**

LINEAR LIGHT



**ZERO MODULE TECHNOLOGY**

CUT IT WHEREVER YOU WANT



**MULTIBENDING**

ONE VERSION,  
MULTIPLE BENDING DIRECTIONS



**TRANSPARENT CAPS**

INFINITE CONTINUOUS LIGHT LINES

## MAIN CHARACTERISTICS



Rev02

- One version only, multiple bending directions.
- **ZERO MODULE** / Cut it in any desired point without respecting a cutting unit/module.
- Producible with a longer terminal, cuttable on field during installation, for a perfect final fitting.
- Transparent end caps for a “zero gap” joints during extra long installations.
- Four different cable exit options.
- Produced through an advanced extra white silicon extrusion process, compared with a traditional PVC sheathing (PVC looks yellowish), lighter in terms of weight, more flexible, strong impact resistant and with a high weather resistance.
- Custom circuits on request (°K, CRI)
- Perfectly uniform dot-free smooth and comfortable lighting.
- IP67 for indoor and outdoor use, can be installed on surface mount or flush mount configuration.
- UV resistant
- PWM dimmable
- 5 year warranty (internal use) / 3 years warranty (outdoor use).

## BEST ADVANTAGE

## CUT IT WHEREVER YOU NEED

**ZERO MODULE** is a technology which allows you to **cut LUXYLED wherever you need** without respecting any fixed and predetermined cutting point. Thanks to it, each installation regardless its length and complexity, will be always and constantly perfect.

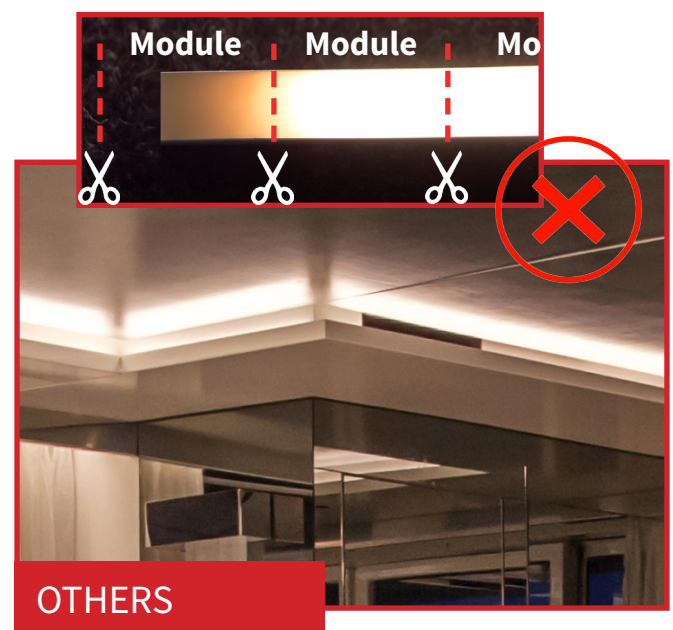
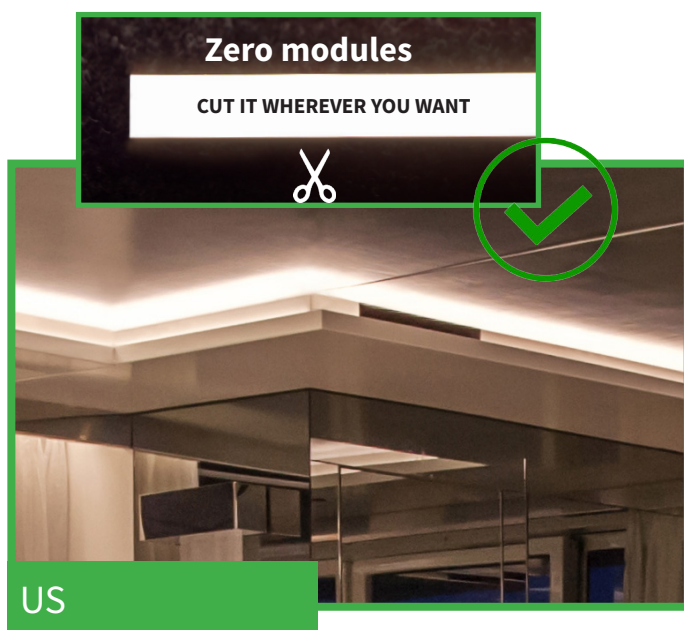

# LUXYLED EVO10 MULTIBENDING - [10x10mm [0,39x0,39in]]



## PARAMETERS

Type	Bending	Dimension	Cutting Unit	IP Rating	Operating temp.	Lifespan	Beam Angle	Min. bend. radius
Luxyled Evo10 Multibending	Multibending	W10xH10mm W0,39xH0,39in	<b>ZERO MODULES TECHNOLOGY</b> <i>cut it wherever you want</i>	IP67	Ta: -20~45°C -4~113°F	50,000h(indoor) 36,000h(outdoor) (Tc ≤65°C[149°F])	120°	SIDE BEND 60mm 2,36in ..... TOP BEND 60mm 2,36in

Type	W	Max. Length Single Feed	Max. Length Double Feed	V	K	Warranty (Indoor)	Warranty (Outdoor)
Luxyled Evo10 Multibending	9W/m 2,74W/ft	5m 16,4ft	10m 32,8ft	24Vdc	2700K 3000K 4000K 5000K	5 years	3 years

## MULTIBENDING: THE POWER OF VERSATILITY



# LUXYLED EVO10 MULTIBENDING - [10x10mm [0,39x0,39in]]



## PART NUMBER BUILDER

	V [A]	W [B]	K [C]	POW.CAP A [D]	ENDCAP/POW.CAP B [E]
	24 - 24Vdc	9 - 9W/m 2,74W/ft	27 - 2700K 30 - 3000K 40 - 4000K 50 - 5000K	1 - LINE 2 - SIDE LEFT 3 - SIDE RIGHT 4 - BOTTOM	0 - END CAP 5 - LINE 6 - SIDE LEFT 7 - SIDE RIGHT 8 - BOTTOM
EVO10M	—	—	—	—	—

EXAMPLE : EVO10M 

2	4	9	4	0	4	8
[A]	[B]	[C]	[D]	[E]		

      LENGTH → m   
ft

DIMMING PROTOCOLS →

DALI	KNX	0-10	ELV / MLV	OTHERS
<input type="checkbox"/>	<input type="checkbox"/>	<input type="checkbox"/>	<input type="checkbox"/>	<input type="checkbox"/>

FIXING →

ANOD. ALU. CHANNEL	BENDABLE CHANNEL	ALUMINUM CLIP
<input type="checkbox"/> PTLUXEVO10MALBAR1	<input type="checkbox"/> PTLUXEVO10MALBARBND	<input type="checkbox"/> PTLUXEVO10MALCLIP

## DELIVERED LUMEN VALUES

	EVO10 MULTIBENDING		
	CRI LED	Lm/m	Lm/ft
WHITE	2700K	83	533
	3000K	84	558
	4000K	84	574
	5000K	84	579

**CABLE EXIT**

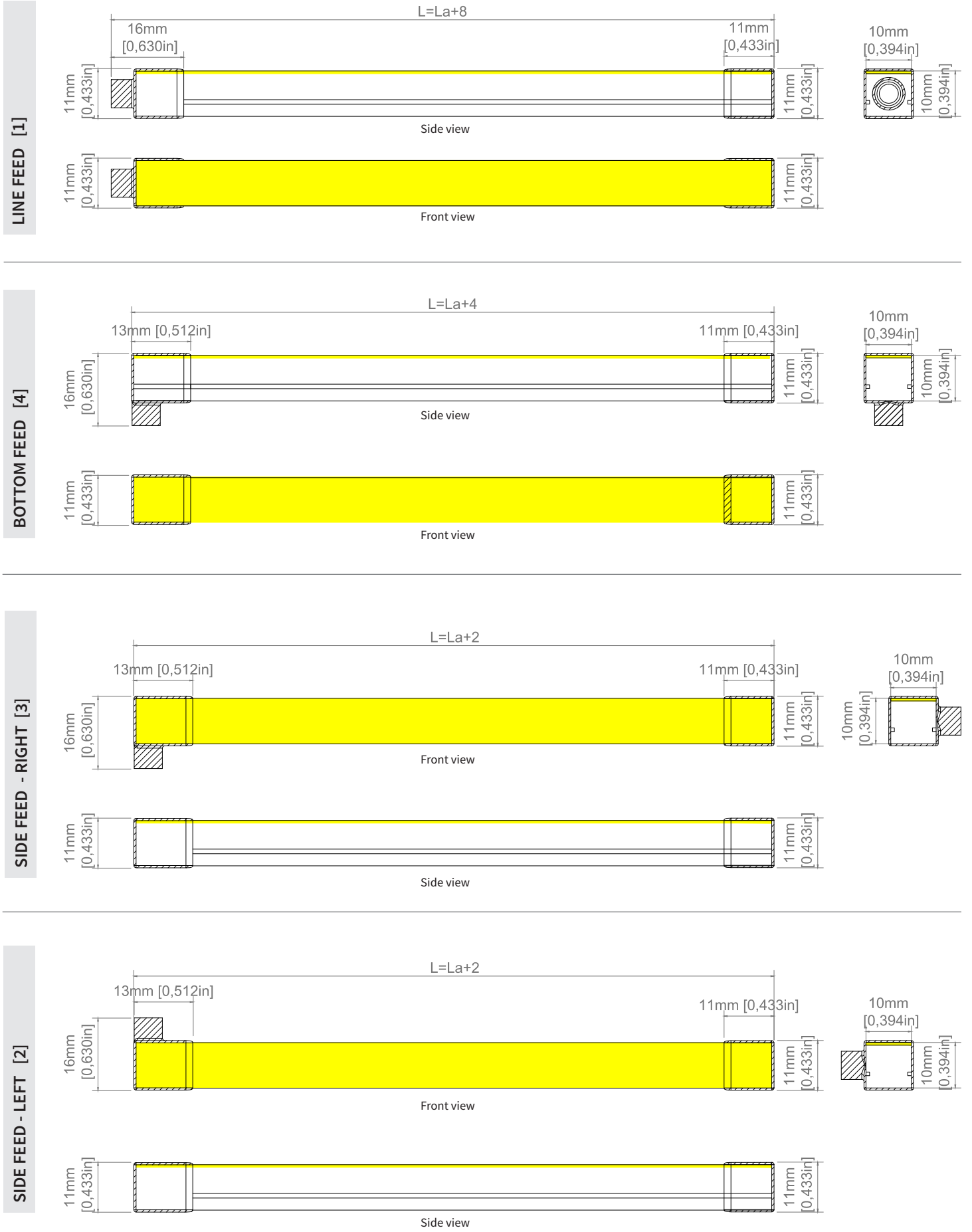

## CABLE EXIT OPTIONS

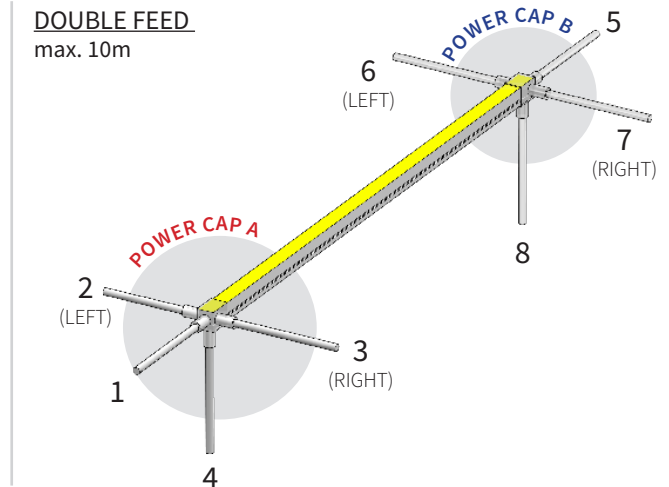
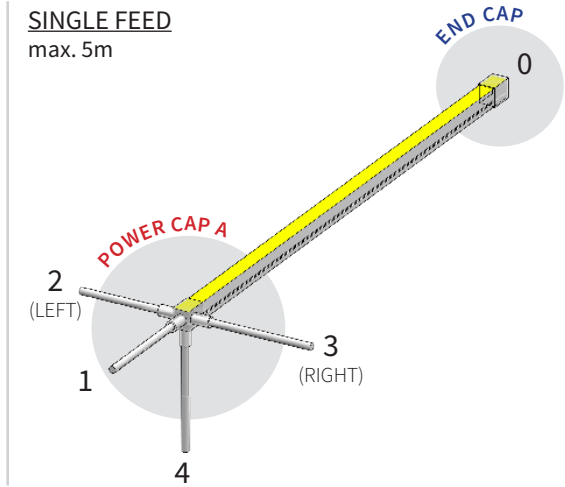

- |                            |                                 |
|----------------------------|---------------------------------|
| <b>POWER CAP A</b>         | <b>POWER CAP B / END CAP</b>    |
| <b>1</b> - LINE FEED       | <b>0</b> - END CAP(single feed) |
| <b>2</b> - SIDE LEFT FEED  | <b>5</b> - LINE FEED            |
| <b>3</b> - SIDE RIGHT FEED | <b>6</b> - SIDE LEFT FEED       |
| <b>4</b> - BOTTOM FEED     | <b>7</b> - SIDE RIGHT FEED      |
|                            | <b>8</b> - BOTTOM FEED          |

## BENDING RULES

### LUXYLED EVO 10 MULTIBENDING

MINIMUM BENDING RADIUS / SIDE BEND  $r > 60\text{mm}$  [2,36in]

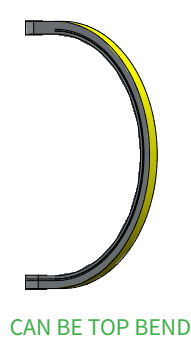
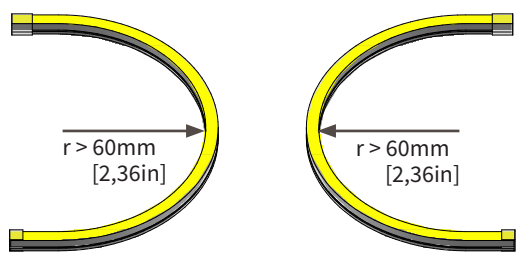

MINIMUM BENDING RADIUS / TOP BEND  $r > 60\text{mm}$  [2,36in]

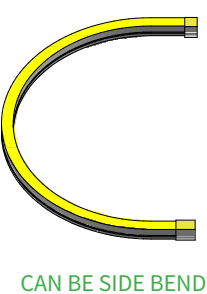
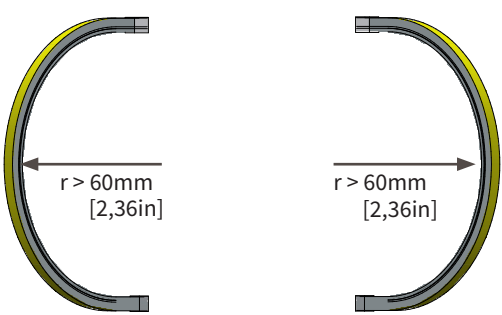



ZERO GAP

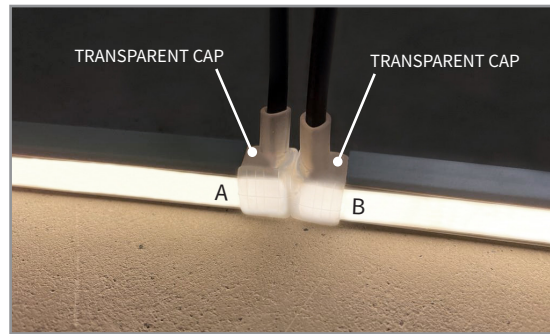
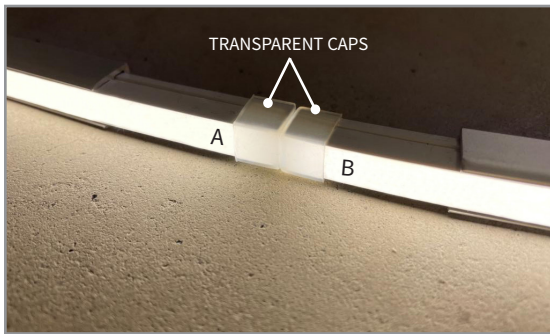
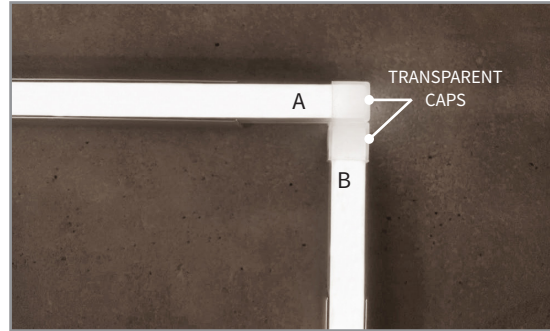
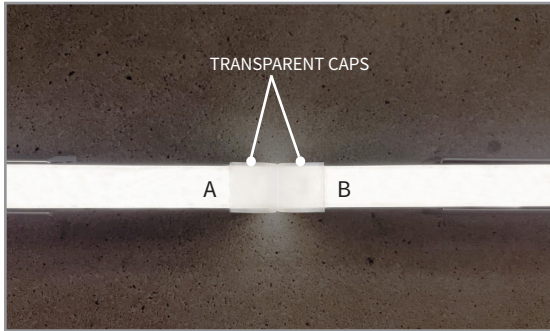
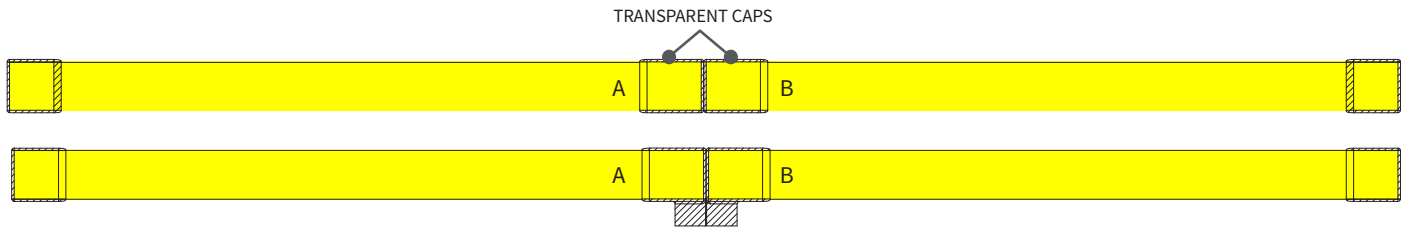

Transparent caps for a "zero gap" joint during extra long installations.

FIXING ACCESSORIES

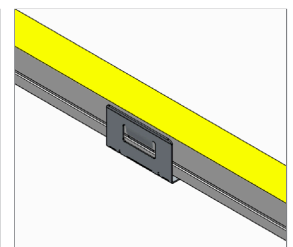
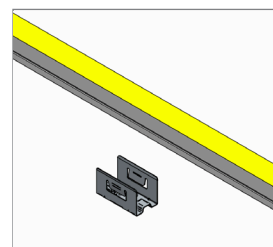
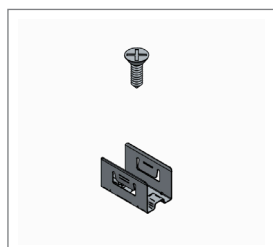
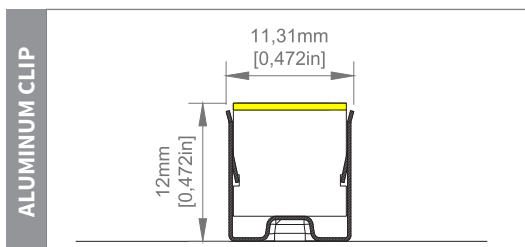
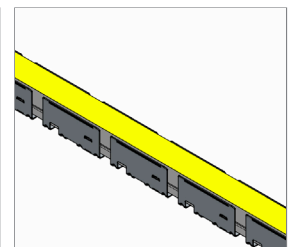
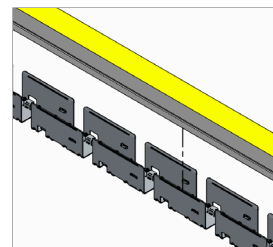
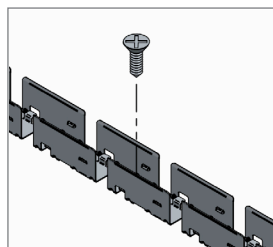
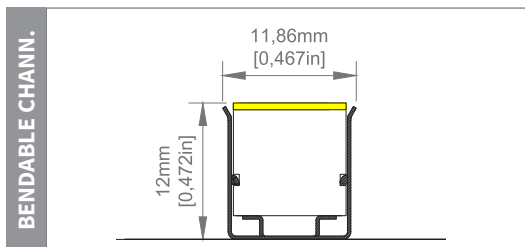
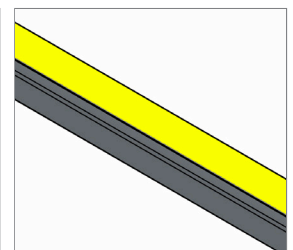
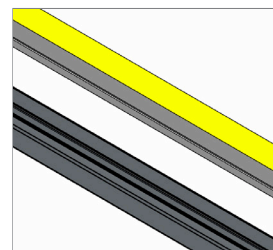
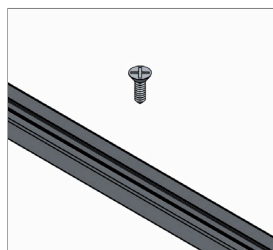
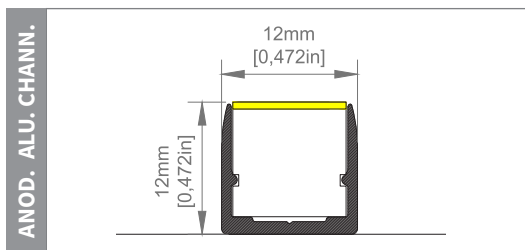

LIGHT DISTRIBUTION DIAGRAM

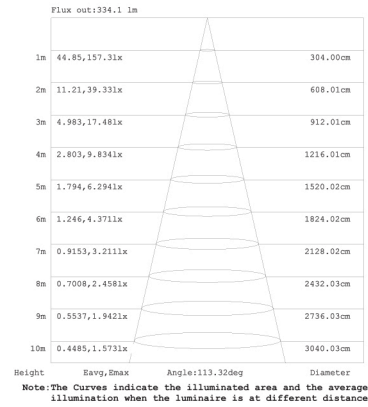
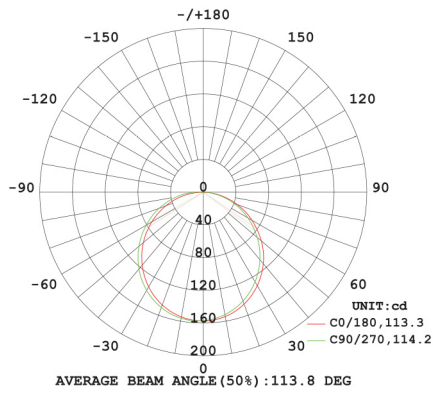

EVO10 MULTIBENDING/ WHITE / 4000K



## LUXYLED COLLECTION

	SIZE (Light output from W)	SIDE BEND	TOP BEND	MULTI BENDING	ZERO <sup>*</sup> MODULES	12V	24V	WHITE	TUNABLE WHITE	DIM TO WARM	RGB	RGBW	IP67	LUMEN
LUXYLED EVO3 & 3FR	W3xH6mm W0,12xH0,24in	●	-	-	●	-	●	●	-	-	-	-	●	270 lm/m 82lm/ft (4000K)
LUXYLED EVO4 & 4FR	W4xH8,5mm W0,16xH0,33in	●	-	-	●	●	●	●	-	-	-	-	●	218 lm/m 66lm/ft (4000K)
LUXYLED EVO8	W8xH8mm W0,31xH0,31in	●	●	-	●	-	●	●	-	-	-	-	●	450lm/m 137lm/ft (4000K)
LUXYLED EVO8.5	W8,5xH10mm W0,33xH0,39in	●	●	-	●	●	●	●	-	-	-	-	●	559 lm/m 170lm/ft (4000K)
LUXYLED EVO8.8	W8,8xH16,5mm W0,35xH0,65in	●	-	-	●	-	●	●	-	-	●	●	●	350 lm/m 110lm/ft (3000K)
LUXYLED EVO10 MULTIBENDING	W10xH10mm W0,39xH0,39in	-	-	●	●	-	●	●	-	-	-	-	●	450 lm/m 137m/ft (4000K)
LUXYLED EVO13	W13xH13mm W0,5xH0,5in	●	●	-	●	-	●	●	-	-	●	-	●	830 lm/m 250lm/ft (3000K)
LUXYLED EVO13HE	W13xH13mm W0,5xH0,5in	●	●	-	●	-	●	●	●	-	●	●	●	1200 lm/m 366lm/ft (3000K_TOP)
LUXYLED EVO19 TOP	W20xH20mm W0,79xH0,79in	-	●	-	-	-	●	●	●	●	●	●	●	650lm/m 198lm/ft (4000K)
LUXYLED EVO19 SIDE	W10xH20mm W0,39xH0,79in	●	-	-	●	-	●	●	●	●	●	●	●	535lm/m 160lm/ft (4000K)
LUXYLED EVO OMNIA	W16xH16mm W0,63xH0,63in	-	-	●	●	-	●	●	●	●	●	-	●	840lm/m 260lm/ft (4000K)
LUXYLED EVO OMNIA RGBW	W23xH23mm W0,9xH0,9in	-	-	●	-	-	●	-	-	-	-	●	●	498lm/m 152lm/ft (4000K)
LUXYLED EVO360	Ø 18mm Ø 0,71in	-	-	●	●	-	●	●	-	-	-	-	●	1150lm/m 350lm/ft (4000K)
LUXYLED EVO COBRA	W23xH23mm W0,9xH0,9in	-	-	●	-	-	●	●	●	-	-	-	●	1994lm/m 608lm/ft (4000K)
LUXYLED EVO COBRA RGB/RGBW	W34xH25mm W1,3xH0,98in	-	-	●	-	-	●	-	-	-	●	●	●	1186m/m 361lm/ft (4000K)

ZERO MODULE\* technology not available for RBG and RGBW

CHECK HERE LUXYLED APPLICATIONS



SCAN