

LINEAR LIGHT LINE

# LUXYLED EVO OMNIA

## ZERO MODULE TECHNOLOGY

CUT IT WHEREVER YOU WANT  
(WHITE/CCT/DIM TO WARM)



## HI LUMEN OUTPUT

ONE OF THE BRIGHTEST MODEL IN THE LUXYLED RANGE

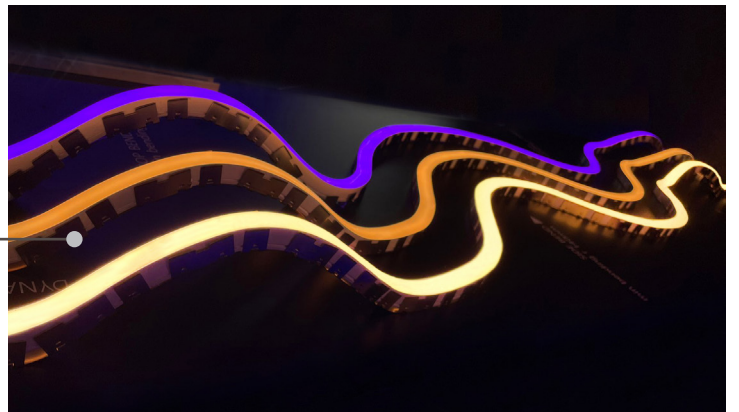

## MULTIBENDING & MULTICIRCUIT

CAN BE BENDED IN ANY DIRECTION AND  
USES DIFFERENT CIRCUITS

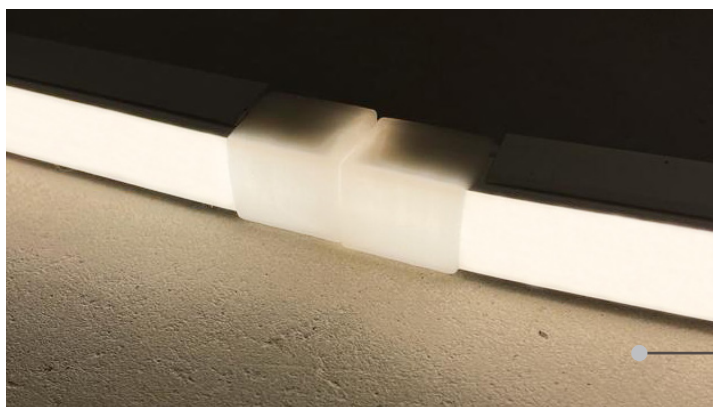

## TRANSPARENT CAPS

INFINITE CONTINUOUS LIGHT LINES

## MAIN CHARACTERISTICS



- One version only, multiple bending directions.
- One version only, four different circuits ( W/CCT/DIM TO WARM/RGB)
- HI lumen output (743lm/m @ 3000K)
- Custom circuits on request (\*K, CRI)
- Perfectly uniform dot-free smooth and comfortable lighting, up to 20m(65,6ft) run length (no RGB).
- IP67 for indoor and outdoor use, can be installed on surface mount or flush mount configuration.
- UV resistant
- PWM dimmable
- 5 year warranty (internal use) / 3 years warranty (outdoor use).
- Anodized aluminum fixing channel, bendable channel, clips and brackets.

## BEST ADVANTAGE

### CUT IT WHEREVER YOU NEED (NO RGB)

**ZERO MODULE** is a technology which allows you to **cut LUXYLED wherever you need** without respecting any fixed and predetermined cutting point. Thanks to it, each installation regardless its length and complexity, will be always and constantly perfect.

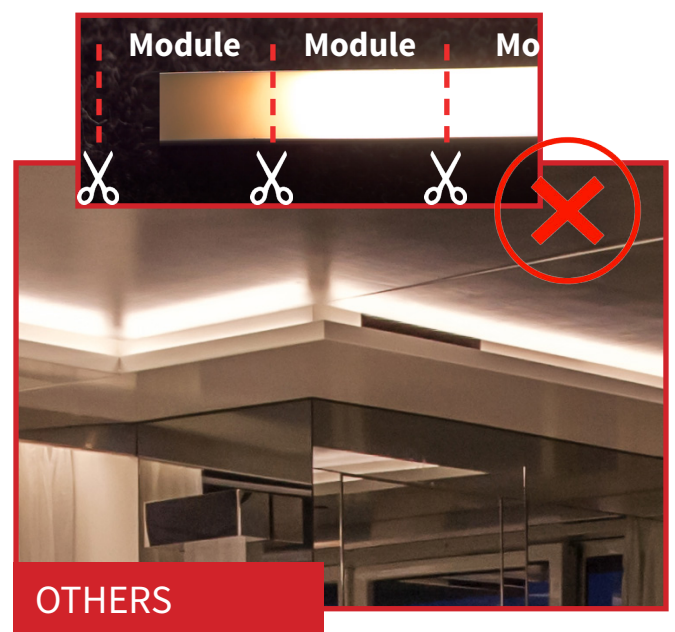
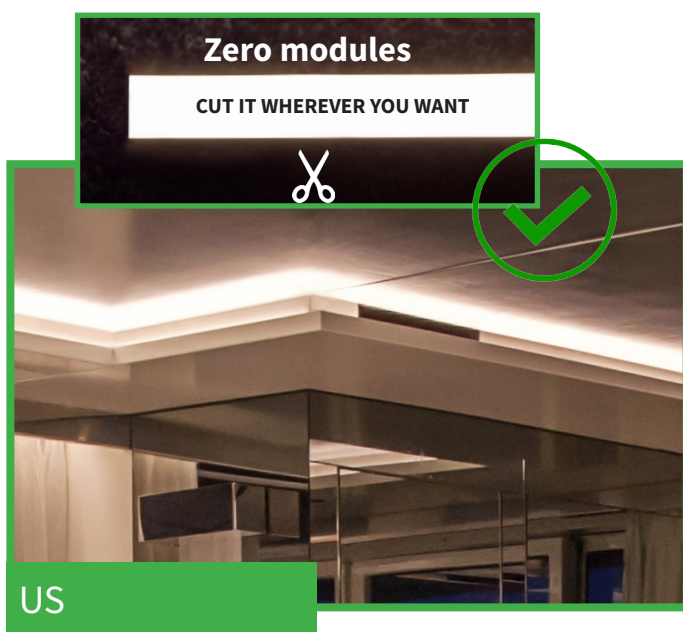

## PARAMETERS

| Type                            | Bending      | Dimension                  | Cutting Unit  | IP Rating   | Operating temp.          | Lifespan   | Beam Angle | Min. bend. radius   |
|---------------------------------|--------------|----------------------------|---|-------------|--------------------------|--|------------|---|
| Luxyled Evo OMNIA (White)       | Multibending | W16xH16mm<br>W0,63xH0,63in | <b>ZERO MODULES TECHNOLOGY</b><br><i>cut it wherever you want</i> | IP20 - IP67 | Ta: -20~45°C<br>-4~113°F | 50,000h (white/cct/rgb/rgbw for indoor)<br><br>36,000h (white/cct/rgb/rgbw for outdoor, SPI/DMX for indoor/outdoor)<br><br>(Tc ≤65°C[149°F]) | 120°       | SIDE BEND<br>140mm<br>5,51in<br>.....<br>TOP BEND<br>60mm<br>2,93in |
| Luxyled Evo OMNIA (Tunable)     |              |                            |   |             |                          |  |            |   |
| Luxyled Evo OMNIA (DIM TO WARM) |              |                            |   |             |                          |  |            |   |
| Luxyled Evo OMNIA (RGB)         |              |                            | 50mm<br>1,97in  |             |                          |  |            |   |

| Type                            | W                | Max. Length Single Feed  | Max. Length Double Feed | V     | K                                |
|---------------------------------|------------------|--------------------------|-------------------------|-------|----------------------------------|
| Luxyled Evo OMNIA (White)       | 14W/m<br>4,3W/ft | 10m<br>32,8ft            | 20m<br>65,6ft           | 24Vdc | 2700K<br>3000K<br>4000K<br>5000K |
| Luxyled Evo OMNIA (Tunable)     |                  |                          |                         |       | Tunable [2700-6000K]             |
| Luxyled Evo OMNIA (DIM TO WARM) |                  | Dim to warm [1800-3000K] |                         |       |                                  |
| Luxyled Evo OMNIA (RGB)         |                  | 5m<br>16,4ft             | 10m<br>32,8ft           |       | RGB                              |

| Warranty (Indoor) | Warranty (Outdoor) |
|-------------------|--------------------|
| 5 years           | 3 years            |

## MULTIBENDING: THE POWER OF VERSATILITY

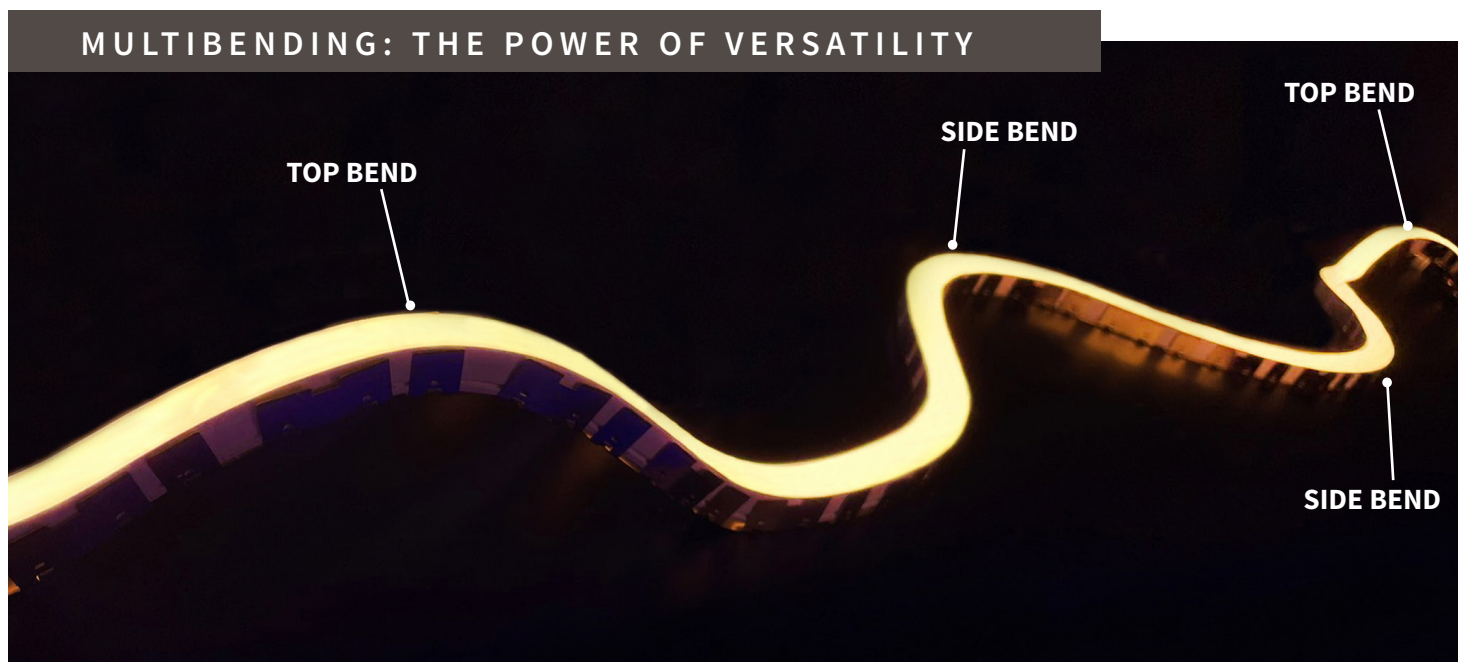

## PART NUMBER BUILDER

|          | V [A]      | W [B]                 | K [C]  | POW.CAP A [D]   | ENDCAP/POW.CAP B [E]  |
|----------|------------|-----------------------|--|---|---|
|          | 24 - 24Vdc | 14 - 14W/m<br>4,3W/ft | 27 - 2700K<br>30 - 3000K<br>40 - 4000K<br>50 - 5000K<br>2760 - Tunable white<br>1830 - DTW (1800-3000K)<br>RGB - RGB | 1 - LINE<br>2 - SIDE LEFT<br>3 - SIDE RIGHT<br>4 - BOTTOM | X - NO END CAP [IP20]<br>0 - END CAP<br>5 - LINE<br>6 - SIDE LEFT<br>7 - SIDE RIGHT<br>8 - BOTTOM |
| EVOOMNIA | —          | —                     | —  | —   | —   |

EXAMPLE : EVOOMNIA 

|     |     |     |     |     |   |   |   |
|-----|-----|-----|-----|-----|---|---|---|
| 2   | 4   | 1   | 4   | 5   | 0 | 2 | X |
| [A] | [B] | [C] | [D] | [E] |   |   |   |

 LENGTH m  ft

### DIMMING PROTOCOLS

|                               |                              |                               |                                    |                                 |
|-------------------------------|------------------------------|-------------------------------|------------------------------------|---------------------------------|
| <input type="checkbox"/> DALI | <input type="checkbox"/> KNX | <input type="checkbox"/> 0-10 | <input type="checkbox"/> ELV / MLV | <input type="checkbox"/> OTHERS |
|-------------------------------|------------------------------|-------------------------------|------------------------------------|---------------------------------|

### FIXING

|  |  |
|--|--|
| <input type="checkbox"/> ANOD. ALU. CHANNEL<br>PTLUXEVOOMNIAALBAR1 | <input type="checkbox"/> BENDABLE CHANNEL<br>PTLUXEVOOMNIAALBARBND |
| <input type="checkbox"/> PLASTIC BRACKET<br>PTLUXEVOOMNIAPLBR      | <input type="checkbox"/> PLASTIC CLIP<br>PTLUXEVOOMNIAPLCLIP       |

## DELIVERED LUMEN VALUES

| WHITE   | LED CRI | EVO OMNIA<br>14W/m - 4,3 W/ft |       |
|---------|---------|-------------------------------|-------|
|         |         | Lm/m                          | Lm/ft |
| ● 2700K | 94      | 698                           | 213   |
| ● 3000K | 93      | 743                           | 227   |
| ● 4000K | 94      | 795                           | 242   |
| ● 5000K | 95      | 779                           | 237   |

| TUNABLE       | LED CRI | EVO OMNIA<br>14W/m - 4,3 W/ft |       |
|---------------|---------|-------------------------------|-------|
|               |         | Lm/m                          | Lm/ft |
| ● 2700K-6000K | 91      | 608                           | 185   |

| RGB     | Wavelength | EVO OMNIA<br>14W/m - 4,3 W/ft |       |
|---------|------------|-------------------------------|-------|
|         |            | Lm/m                          | Lm/ft |
| ● RED   | 615-630nm  |                               |       |
| ● GREEN | 515-525nm  |                               |       |
| ● BLUE  | 460-470nm  |                               |       |

| DIM TO WARM   | LED CRI | EVO OMNIA<br>14W/m - 4,3 W/ft |       |
|---------------|---------|-------------------------------|-------|
|               |         | Lm/m                          | Lm/ft |
| ● 1800K-3000K | 91      | 608                           | 185   |

CABLE EXIT

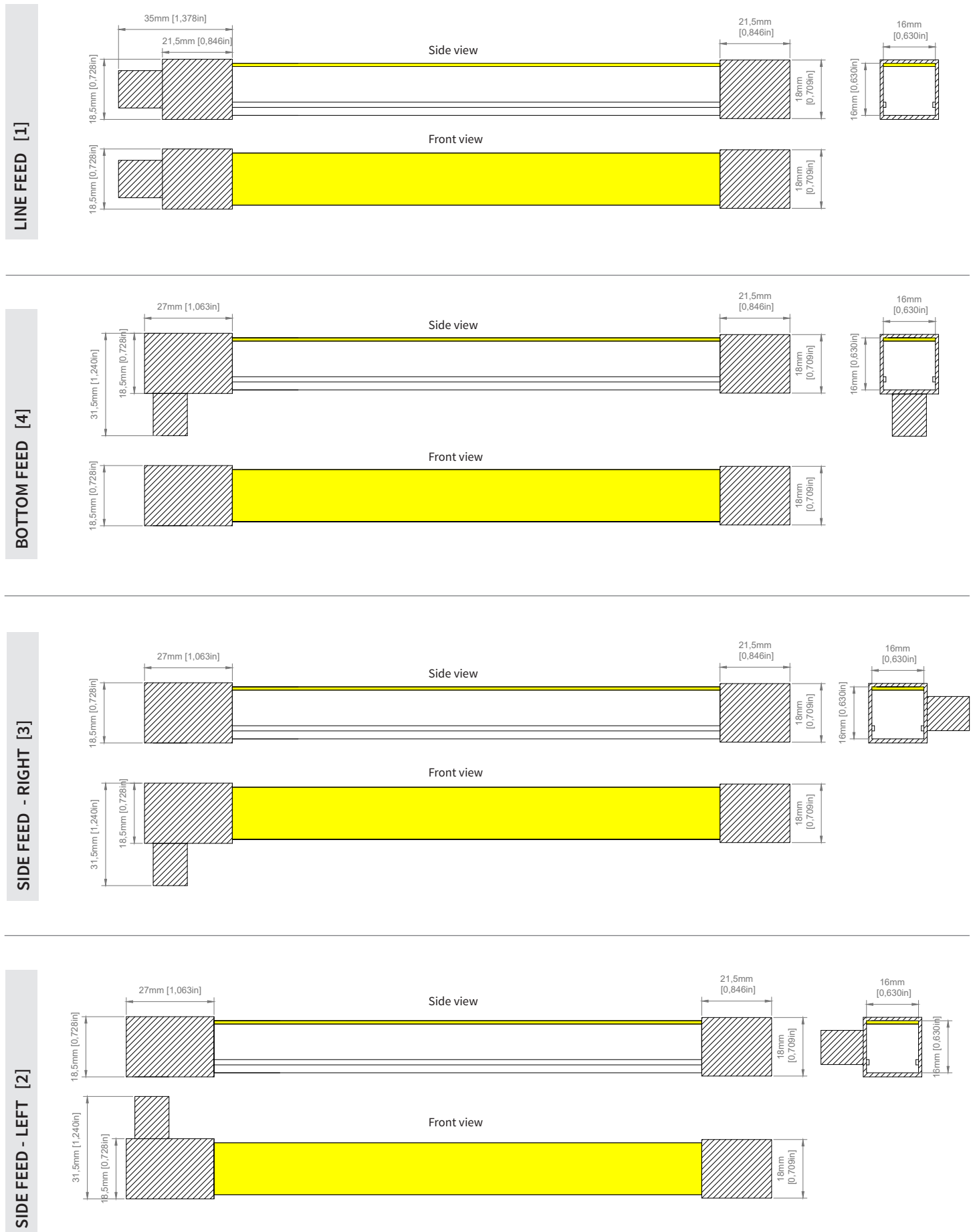



## CABLE EXIT OPTIONS

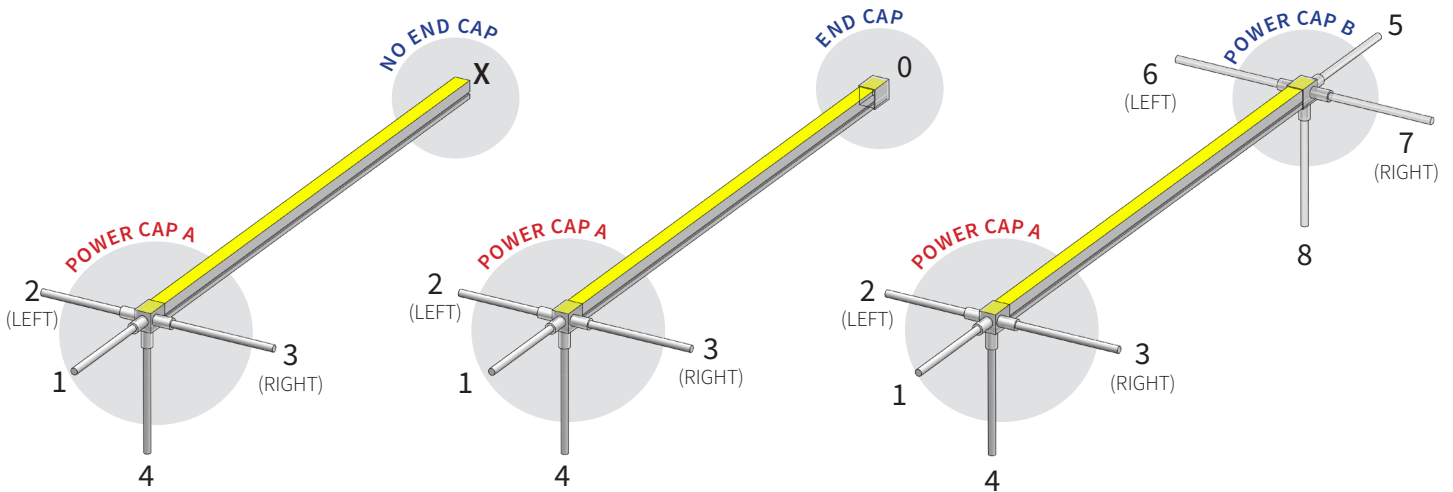

**SINGLE FEED - IP20**  
max. 10m @ White/Tunab./Dim to warm  
max. 5m @ RGB

**SINGLE FEED - IP67**  
max. 10m @ White/Tunab./Dim to warm  
max. 5m @ RGB

**DOUBLE FEED - IP67**  
max. 20m @ White/Tunab./Dim to warm  
max. 10m @ RGB

**POWER CAP A**

- 1 - LINE FEED
- 2 - SIDE LEFT FEED
- 3 - SIDE RIGHT FEED
- 4 - BOTTOM FEED

**POWER CAP B / END CAP**

- X - NO END CAP (IP20)
- 0 - END CAP (single feed)
- 5 - LINE FEED
- 6 - SIDE LEFT FEED
- 7 - SIDE RIGHT FEED
- 8 - BOTTOM FEED

## BENDING RULES

### LUXYLED EVO OMNIA - MULTIBENDING

MINIMUM BENDING RADIUS / SIDE BEND  $r > 140\text{mm}$  [5,51in]

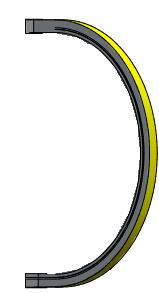
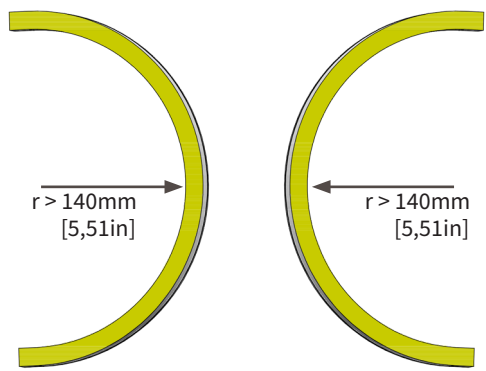

CAN BE TOP BEND

MINIMUM BENDING RADIUS / TOP BEND  $r > 60\text{mm}$  [2,93in]

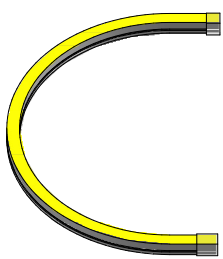
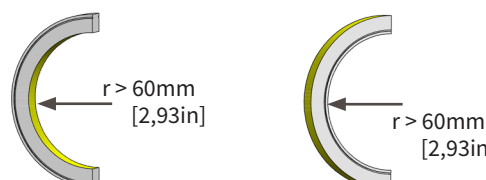

CAN BE SIDE BEND

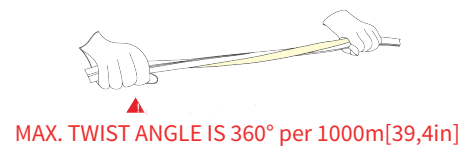

## ZERO GAP

### IP67 OUTDOOR APPLICATION - END CAPS

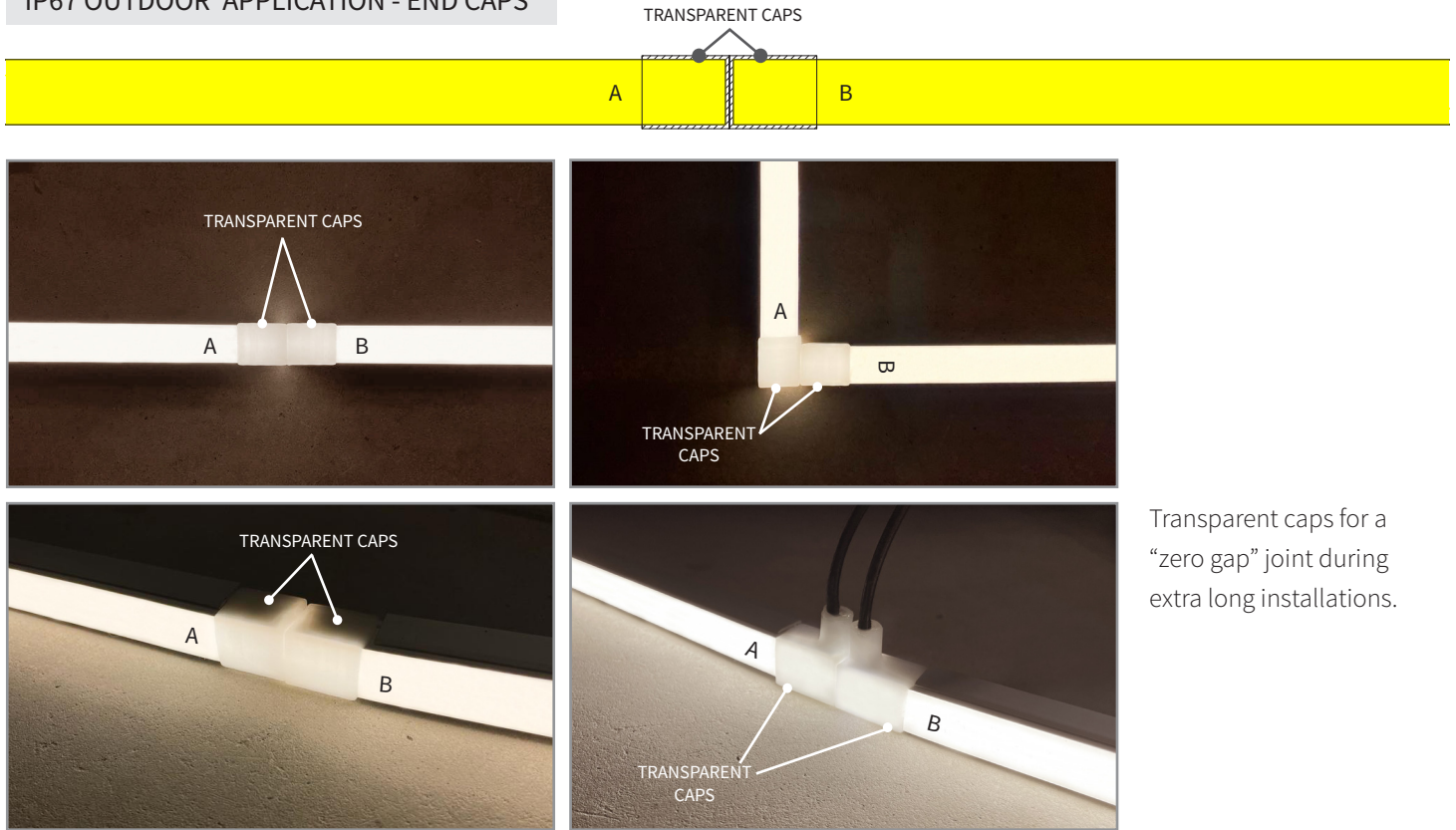

Transparent caps for a “zero gap” joint during extra long installations.

### IP20 INDOOR APPLICATION - NO END CAPS

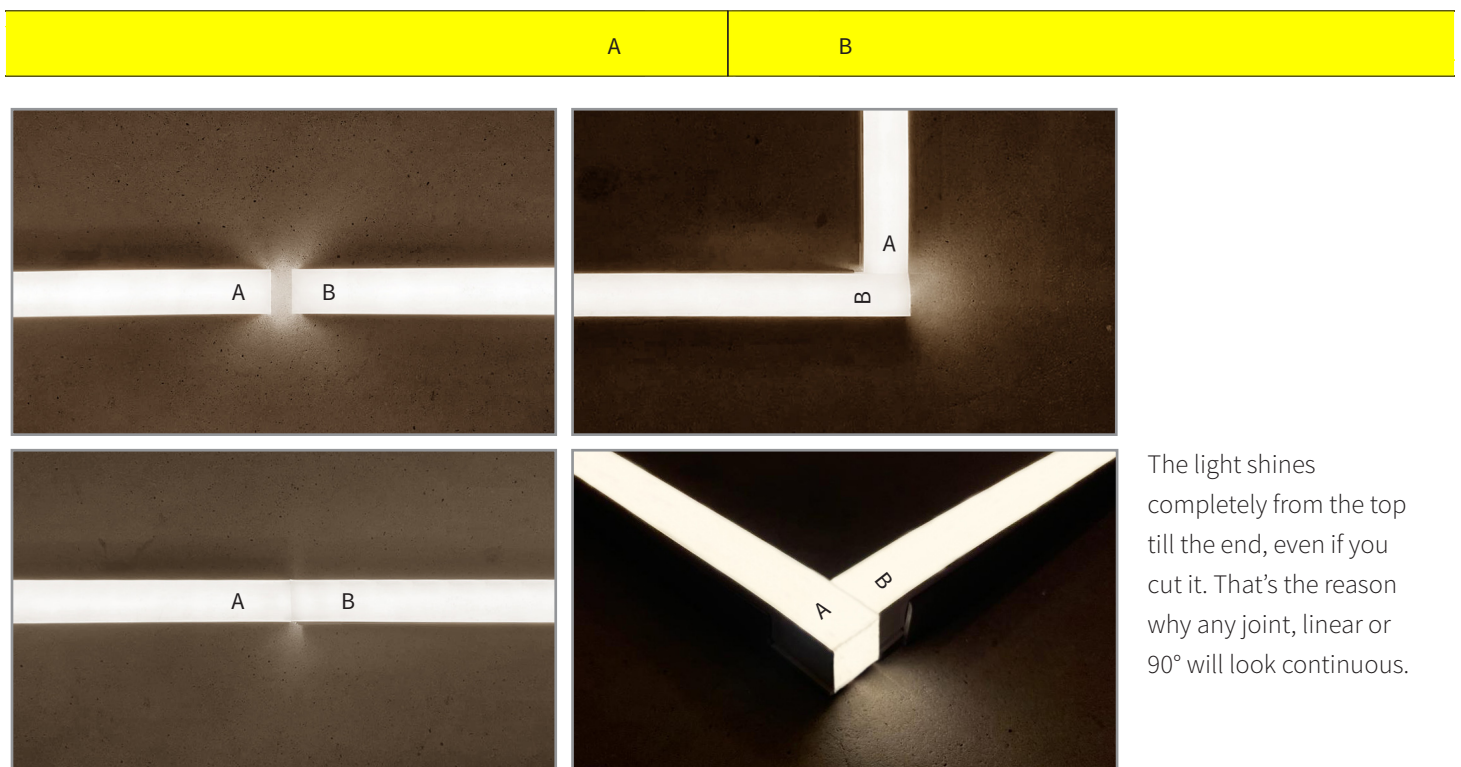

The light shines completely from the top till the end, even if you cut it. That's the reason why any joint, linear or 90° will look continuous.

FIXING ACCESSORIES

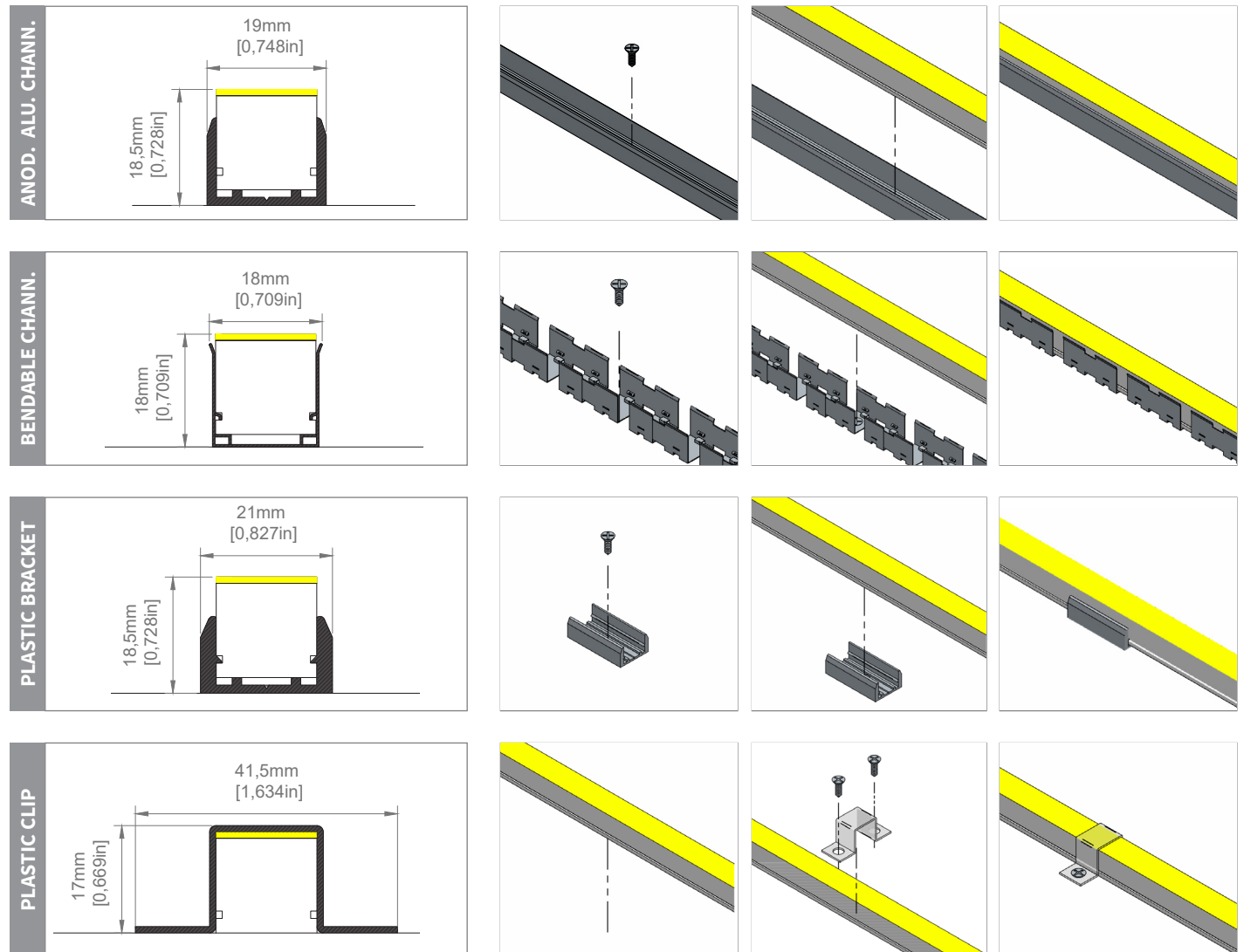



# LUXLED EVO OMNIA - [16x16mm [0,63x0,63in]]



## LIGHT DISTRIBUTION DIAGRAM

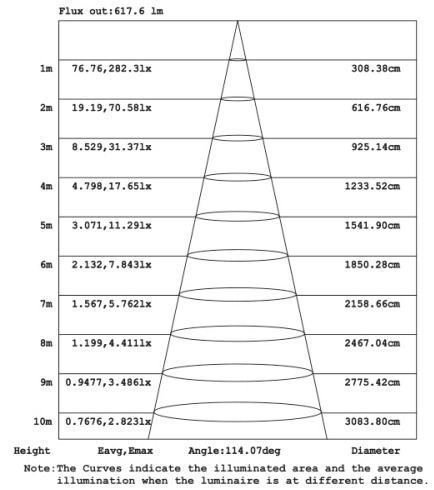
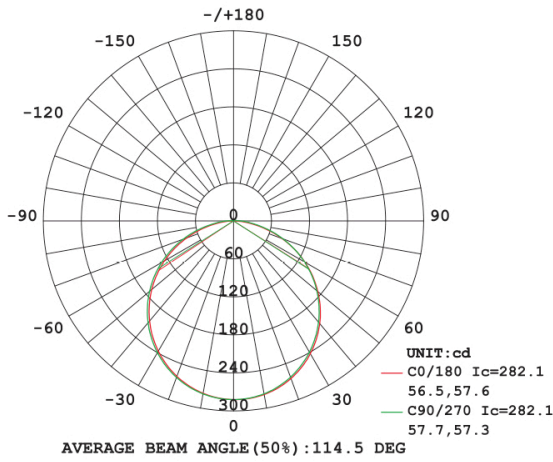

EVO OMNIA / WHITE / 4000K

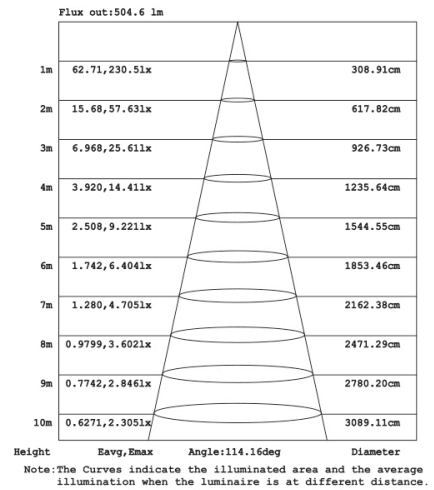
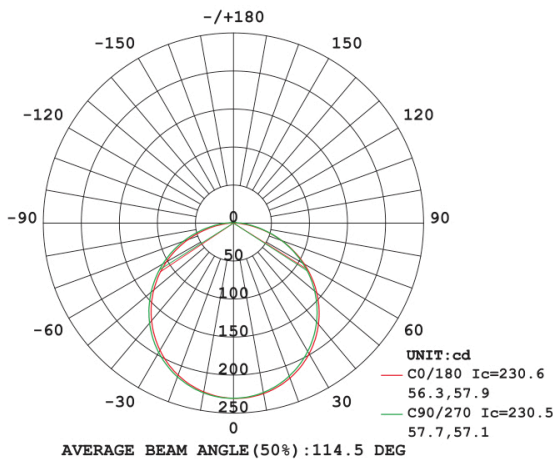

EVO OMNIA / TUNABLE/ 2700-6500K

## LUXYLED COLLECTION

|                               | SIZE<br>(Light output from W) | SIDE<br>BEND | TOP<br>BEND | ZERO<br>MODULES* | 12V | 24V | WHITE | TUNABLE<br>WHITE | DIM TO<br>WARM | RGB | RGBW | IP67 | LUMEN                           |
|-------------------------------|-------------------------------|--------------|-------------|------------------|-----|-----|-------|------------------|----------------|-----|------|------|---------------------------------|
| LUXYLED EVO4 & 4FR            | W4xH8,5mm<br>W0,16xH0,33in    | ●            | -           | ●                | ●   | ●   | ●     | -                | -              | -   | -    | ●    | 218 lm/m<br>66lm/ft<br>(4000K)  |
| LUXYLED EVO8.5                | W8,5xH10mm<br>W0,33xH0,39in   | ●            | ●           | ●                | ●   | ●   | ●     | -                | -              | -   | -    | ●    | 559 lm/m<br>170lm/ft<br>(4000K) |
| LUXYLED EVO8.8                | W8,8xH16,5mm<br>W0,35xH0,65in | ●            | -           | ●                | -   | ●   | ●     | -                | -              | ●   | ●    | ●    | 350 lm/m<br>110lm/ft<br>(3000K) |
| LUXYLED EVO10<br>MULTIBENDING | W10xH10mm<br>W0,39xH0,39in    | ●            | ●           | ●                | -   | ●   | ●     | -                | -              | -   | -    | ●    | 450 lm/m<br>137lm/ft<br>(4000K) |
| LUXYLED EVO13                 | W13xH13mm<br>W0,5xH0,5in      | -            | ●           | ●                | -   | ●   | ●     | -                | -              | ●   | -    | ●    | 830 lm/m<br>250lm/ft<br>(3000K) |
| LUXYLED EVO19 TOP             | W20xH20mm<br>W0,79xH0,79in    | -            | ●           | -                | -   | ●   | ●     | ●                | ●              | ●   | ●    | ●    | 650lm/m<br>198lm/ft<br>(4000K)  |
| LUXYLED EVO19 SIDE            | W10xH20mm<br>W0,39xH0,79in    | ●            | -           | ●                | -   | ●   | ●     | ●                | ●              | ●   | ●    | ●    | 535lm/m<br>160lm/ft<br>(4000K)  |
| LUXYLED EVO OMNIA             | W16xH16mm<br>W0,63xH0,63in    | ●            | ●           | ●                | -   | ●   | ●     | ●                | ●              | ●   | -    | ●    | 840lm/m<br>260lm/ft<br>(4000K)  |
| LUXYLED EVO OMNIA<br>RGBW     | W23xH23mm<br>W0,9xH0,9in      | ●            | ●           | -                | -   | -   | -     | -                | -              | -   | ●    | ●    | 498lm/m<br>152lm/ft<br>(4000K)  |
| LUXYLED EVO360                | Ø 18mm<br>Ø 0,71in            | ●            | ●           | ●                | -   | ●   | ●     | -                | -              | -   | -    | ●    | 1150lm/m<br>350lm/ft<br>(4000K) |
| LUXYLED EVO COBRA             | W23xH23mm<br>W0,9xH0,9in      | ●            | ●           | -                | -   | ●   | ●     | ●                | -              | -   | -    | ●    | 1994lm/m<br>608lm/ft<br>(4000K) |
| LUXYLED EVO COBRA<br>RGB/RGBW | W34xH25mm<br>W1,3xH0,98in     | ●            | ●           | -                | -   | ●   | -     | -                | -              | ●   | ●    | ●    | 1186m/m<br>361lm/ft<br>(4000K)  |

ZERO MODULE\* technology not available for RBG and RGBW

CHECK HERE LUXYLED APPLICATIONS

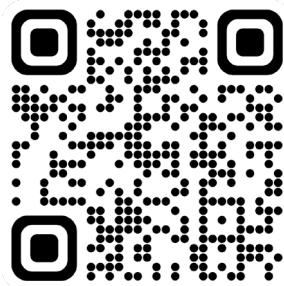

SCAN